



SILBURY
HOUSE

CENTRAL MILTON KEYNES · MK9 2AZ

silburyhousemk.co.uk

Floor Plans

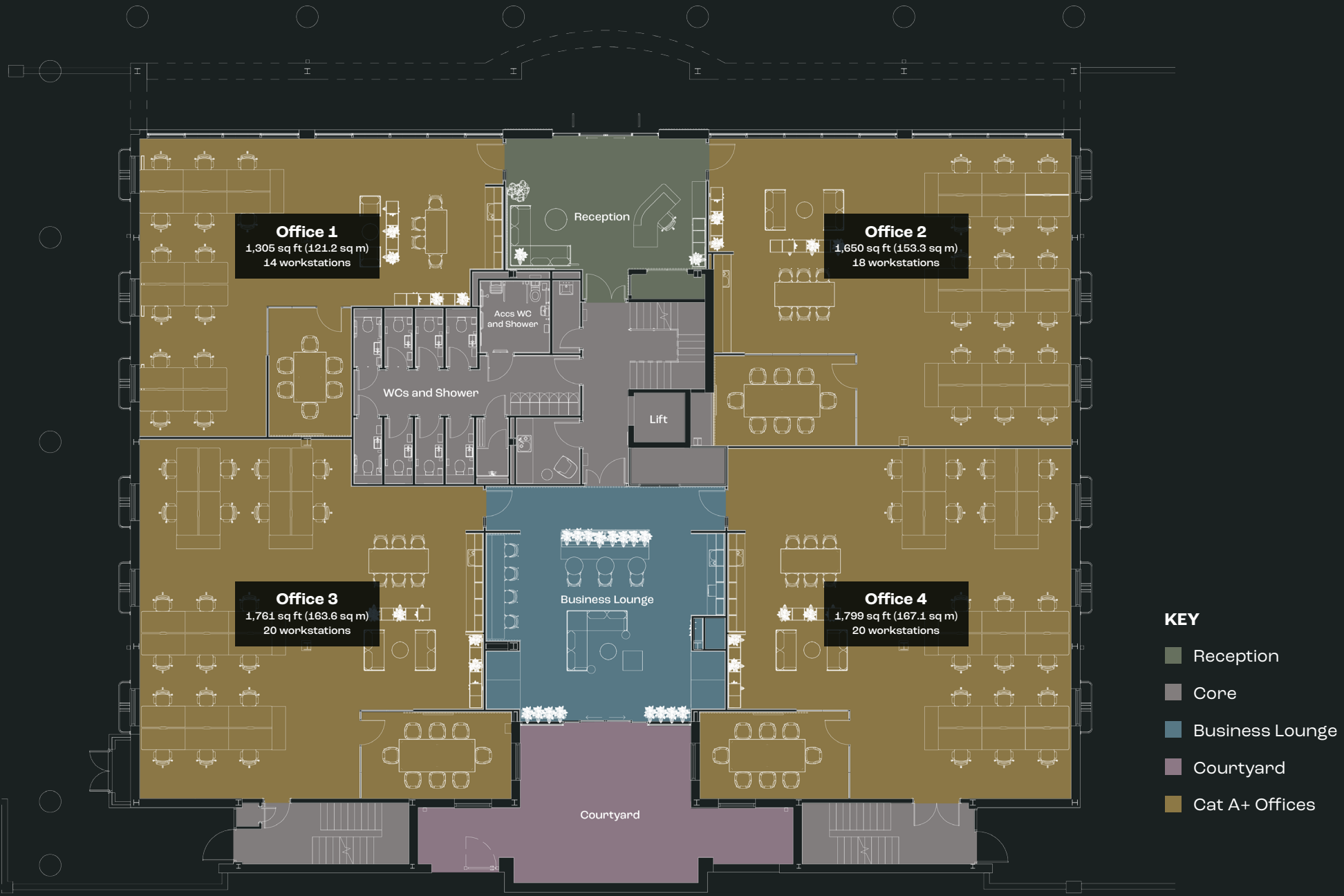

Office 1
1,305 sq ft (121.2 sq m)
14 workstations

Office 2
1,650 sq ft (153.3 sq m)
18 workstations

Office 3
1,761 sq ft (163.6 sq m)
20 workstations

Office 4
1,799 sq ft (167.1 sq m)
20 workstations

- KEY**
- Reception
 - Core
 - Business Lounge
 - Courtyard
 - Cat A+ Offices

Ground floor plan



Second Floor
8,848 sq ft (822 sq m)

First Floor
8,850 sq ft (822.2 sq m)

- KEY**
- Office
 - Cone

Typical upper floor plan

SILBURY
HOUSE

OWNER / DEVELOPER



In business to do business

MEMBER ASSOCIATIONS



JOINT AGENTS

Lambert
Smith
Hampton

TOM HARKER

07702 884 405

tharker@lsh.co.uk

TOM PUGH

07938 737 487

tpugh@lsh.co.uk

bray
fox
smith

IAN LEATHER

07860 612 242

ianleather@brayfoxsmith.com

JOSS BURROWS

07342 341 727

jossburrows@brayfoxsmith.com